

O/E/N 26

MINIATURE HIGH POWER RELAY

- Low Height
- Direct PCB Type
- Dust Protected/ Sealed
- 5kV Dielectric Strength Between Coil & Contacts
- International Standard Footprint
- Compact High Performance
- UL Approved

SPECIFICATIONS

| | |
|---|---|
| Contact Arrangement | : 1 Form A, 1 Form C 1 Form A (K type) 1 Form C (K type) 2 Form A, 2 Form C |
| Contact Material | : Silver Alloy |
| Contact Rating | |
| Rated Voltage | : 250 VAC/ 28 VDC |
| Max. Switching Voltage | : 400 VAC |
| Max. Continuous Current at 230 VAC/ 24 VDC | |
| 1 Form A (K), 1 Form C (K) | : 16 A |
| 1 Form A, 1 Form C | : 12 A |
| 2 Form A, 2 Form C | : 8 A |
| Max. Power Rating | |
| 1 Form C (K type) | : 4000 VAC |
| 1 Form C | : 3000 VAC |
| 2 Form C | : 2000 VAC |
| Nominal Coil Power | : 0.48 W (approx) |
| Life Expectancy | |
| Electrical | : 10 ⁵ operations through NO : 3 x 10 ⁴ operations through NO / NC |
| Mechanical | : 10 ⁶ operations |
| Contact Resistance (Initial) | : 100 milli Ohms |
| Dielectric Strength | |
| Between Contact & Coil | : 5000 VRMS |
| Between Open Contacts | : 1000 VRMS |
| Insulation Resistance | : 1000 MegaOhms at 500 VDC, 25 °C, RH50 |
| Operate Time at | |
| Nominal Voltage | : 10 milli sec.(Typ) |
| Release Time at | |
| Nominal Voltage | : 5 milli sec.(Typ) |
| Ambient Temperature | : -40 °C to +85 °C |
| Weight | : 12 gms (approx) |

Typical Applications :

Industrial Electronics, PLCs, Timers,
Office Automation, UPS, Home Appliances, etc.

All dimensions are in mm. Specifications subject to change without notice. Tolerance unless otherwise specified is ± 10%.

COIL DATA

| Nominal Voltage VDC | Pick-up Voltage VDC | Drop-out Voltage VDC | Coil Resistance Ohms ± 10% |
|---------------------|---------------------|----------------------|----------------------------|
| 5 | 4 | 0.5 | 50 |
| 6 | 4.8 | 0.6 | 75 |
| 12 | 9.6 | 1.2 | 300 |
| 12* | 9.6 | 1.2 | 360 |
| 24 | 19.2 | 2.4 | 1200 |
| 24* | 19.2 | 2.4 | 1440 |
| 48 | 38.4 | 4.8 | 4800 |

*Sensitive version

DIMENSIONS

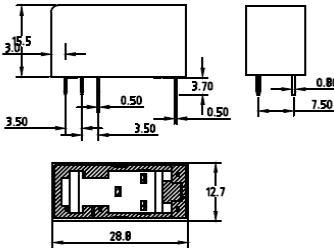

1 Form C (3.5 mm Pinning)

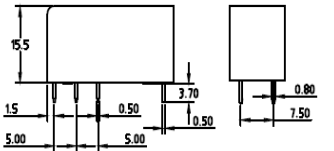

1 Form C (5 mm Pinning)

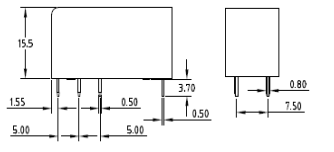

1 Form C(K) & 2 Form C

HOW TO ORDER

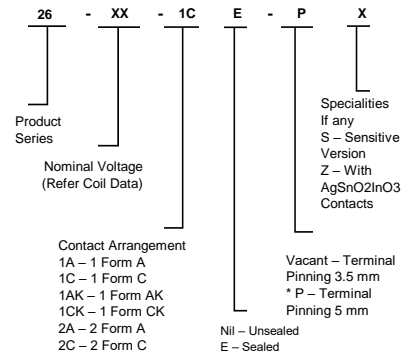

*Dual Pitch option (P version) available only for the Series 26-1A/1C type relays. Form 1AK/1CK & 2A/2C relays has 5mm pinning by default.

WIRING DIAGRAM

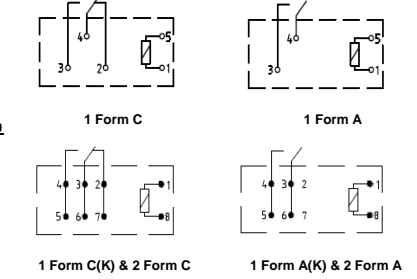

DRILLING PATTERN

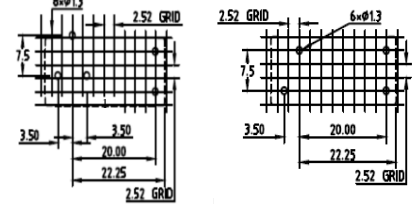

1 Form C (3.5 mm Pinning)

1 Form A (3.5 mm Pinning)

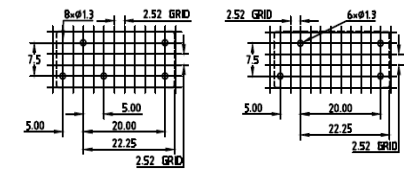

1 Form C (5 mm Pinning)

1 Form A (5 mm Pinning)

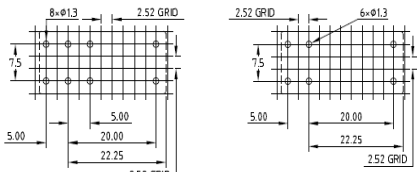

1 Form C(K) & 2 Form C

1 Form A(K) & 2 Form A